

Institutul Agronomic

LEGENDA

- A — A — A conducta alimentare cu apa stradala existenta
- C — C — C canalizare stradala unitara existenta
- AR — AR — AR extindere retea de alimentare cu apa propusa in PUZ
- CM — CM — CM extindere retea canalizare menajera propusa in PUZ
- CP — CP — CP retea canalizare pluviala propusa in PUZ
- cr — cr — cr conducta de refulare ape pluviale propusa
- BR+SP BR+SP BR+SP bazin de retentie si statie de pompare ape pluviale
- SNH SNH SNH separator de namol si hidrocarburi propus
- CL ● CL ● CL camin de linistire
- ↗ H ↗ H ↗ H hidrant suprateran propus in PUZ
- limita de proprietate

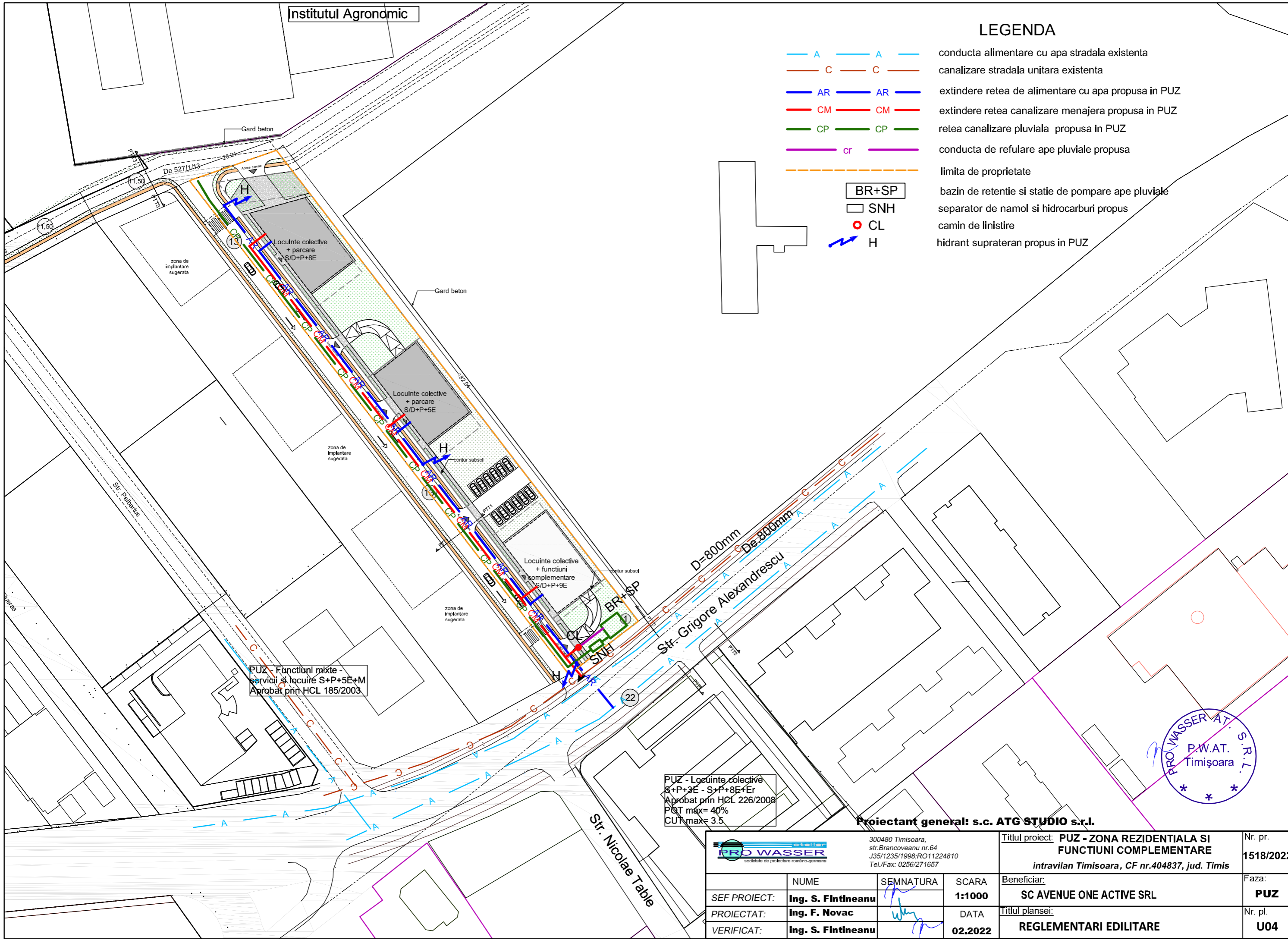



PUZ - Functiuni mixte - servicii si locuinte S+P+5E+M Aprobat prin HCL 185/2003

PUZ - Locuinte colective S+P+3E - S+P+8E+Er Aprobat prin HCL 226/2008  
 PGT max= 40%  
 CUT max= 3.5

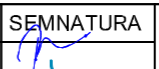

Proiectant generali: s.c. ATG STUDIO s.r.l.

			300480 Timisoara, str. Brancoveanu nr. 64 J35/1235/1998; RO11224810 Tel./Fax: 0256/271657		Titlul proiect: <b>PUZ - ZONA REZIDENTIALA SI FUNCTIUNI COMPLEMENTARE</b> intravilan Timisoara, CF nr.404837, jud. Timis		Nr. pr. <b>1518/2022</b>	
SEF PROIECT: <b>ing. S. Fintineanu</b>			SEMNATURA: 		SCARA: <b>1:1000</b>		Beneficiar: <b>SC AVENUE ONE ACTIVE SRL</b>	Faza: <b>PUZ</b>
PROIECTAT: <b>ing. F. Novac</b>			SEMNATURA: 		DATA: <b>02.2022</b>		Titlul plansei:	Nr. pl. <b>U04</b>
VERIFICAT: <b>ing. S. Fintineanu</b>			SEMNATURA: 		DATA:		<b>REGLEMENTARI EDILITARE</b>	